

## LOCAL AUTHORITIES BOARD

ORDER NO. 4037

FILE: L.A. 145-A

TUESDAY—THE FOURTH DAY OF FEBRUARY, 1969

Before:

The Local Authorities Board  
for the Province of Alberta.

In the matter of The Municipal Government Act:

And in the matter of an application by the Village of Irma for annexation of certain territory lying adjacent thereto.

Pursuant to an application by the Village of Irma dated October 5, 1968 requesting annexation of part of the south-west quarter of section 34, township 45, range 9, west of the fourth meridian, lying adjacent to the village limits, for the purpose of supplying the area with village utility and other services, the land owners of the said area requesting the annexation proposal, the Board on consent of the Village Council, the Municipal District of Wainwright No. 61, the provincial planning director and the Department of Highways has concluded that the application should be granted in full.

In consequence of the Board's review of the matter of the village limits, and after giving notice and obtaining consent of interested parties thereto, the Board has decided on its own motion, that a portion of Highway No. 14 should be separated from the village to provide for single jurisdiction over the subject road.

It is ordered, therefore, that:

I. The following described lands are hereby annexed to the Village of Irma and separated from the Municipal District of Wainwright No. 61:

All that portion of the southerly seven hundred and twenty-six (726) feet of the south-west quarter of section 34, township 45, range 9, west of the fourth meridian not now within the boundaries of the said village, and all that portion of the north-east quarter of section 28 of the said township and range required for road widening as shown on road plan 6306 M.C.

(The general location of these annexed lands is shown on attached Schedule "A".)

II. The following described lands are hereby separated from the Village of Irma and are hereby annexed to the Municipal District of Wainwright No. 61:

All that portion of the said north-east quarter of the said section 28 within road plan 4782 J.Y. not now within the Village boundaries

(The general location of these separated lands is shown on attached Schedule "B".)

III Any arrears of taxes owing to the Municipal District of Wainwright No. 61 as at December 31, 1968 in respect of the properties described in Clause I herein, shall transfer to and become payable to the Village of Irma, together with any lawful penalties and costs levied thereon in respect of such taxes, however, upon the Village of Irma collecting any or all of the said taxes, penalties or costs, such collections shall forthwith be paid by the village to the municipal district concerned.

IV. The assessors for the Village of Irma and the Municipal District of Wainwright No. 61 shall for taxation purposes in the year 1969, re-assess the lands and assessable improvements thereon which are by this

Order annexed to their respective municipalities, so that the assessments resulting therefrom shall be fair and equitable with other related lands and assessable improvements in their respective municipalities

V The Chief provincial assessor, appointed pursuant to the provisions of The Municipalities Assessment and Equalization Act, shall for taxation or grant purposes commencing in the year 1969, reassess or revalue, as the case may be, all properties that are assessable or subject to valuation under the terms of The Electric Power and Pipeline Assessment Act and The Municipal and Provincial Properties Valuation Act, and which lie within the areas that are by this Order annexed to the Village of Irma or the Municipal District of Wainwright No 61, so that the assessment or valuation shall be fair and equitable with properties of a similar nature in the appropriate municipality.

VI. The effective date of this Order shall be the 1st day of January, 1969.

LOCAL AUTHORITIES BOARD,  
C G. MACGREGOR (Chairman).  
I. MORRIS (Member).

Certified a true copy,  
W. C. ELLIOTT (Secretary).

SCHEDULE "A"

A SKETCH SHOWING THE GENERAL LOCATION  
OF THE AREAS AFFECTED BY ORDER No 4037  
EFFECTIVE DATE - JANUARY 1, 1969

 AFFECTED AREA(S)

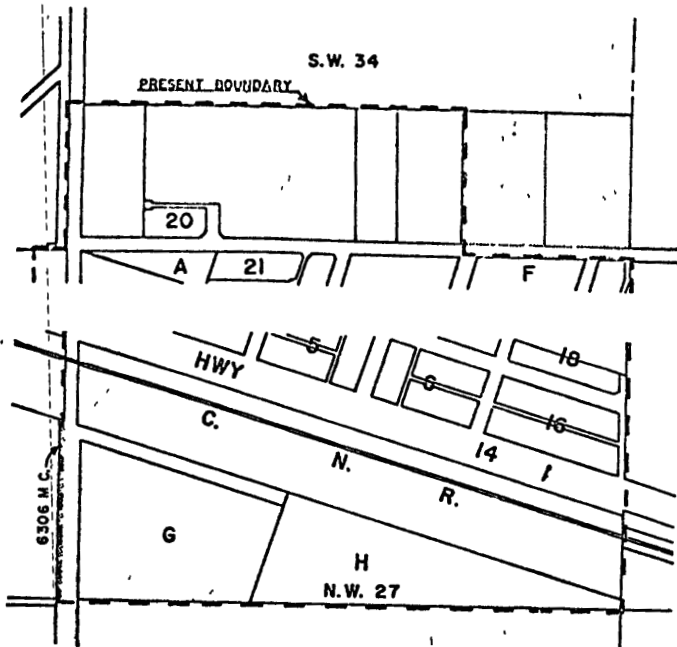

TP. 45 R. 9 W. 4 M.

- IRMA -

# SCHEDULE "B"

A SKETCH SHOWING THE GENERAL LOCATION  
OF THE AREAS AFFECTED BY ORDER No 4037

EFFECTIVE DATE - JANUARY 1, 1969



AFFECTED AREA(S)

