

Before:

The Local Authorities Board for
the Province of Alberta.

In the matter of The Municipal
Government Act:

And in the matter of an appli-
cation by the Town of Sylvan
Lake, Alberta, for annexation of
certain territory lying immedi-
ately adjacent thereto in the
County of Red Deer No. 23.

Pursuant to an application by the Town of Sylvan Lake, in the Province of Alberta, requesting annexation of certain land which lies immediately adjacent to the existing town boundaries, the Board has considered the subject application which would provide land for residential subdivision;

And the Board reviewed the application, together with the consents to the granting of the application received from the registered land owners, the County of Red Deer No. 23, the Red Deer Regional Planning Commission and the Department of Highways and Transport, as well as other relevant material filed with the Board;

And the Board is of the opinion that the application should be granted in full;

It is ordered therefore as follows:

I. That there be annexed to the Town of Sylvan Lake, in the Province of Alberta and thereupon be separated from the County of Red Deer No. 23 the following described territory:

"All that portion of the north-west quarter of section 23, township 38, range 1, west of the fifth meridian which lies to the north of the north-easterly limit of the Alberta Central Railway right-of-way as shown on railway plan 6700 A.N. and not presently within the town boundaries."

(A sketch showing the general location of the annexed lands is attached hereto as schedule "A").

II. Any taxes owing to the County of Red Deer No. 23 as at December 31, 1974 in respect of the aforementioned annexed property shall transfer to and become payable to the Town of Sylvan Lake, together with the amount of any lawful penalties and costs levied thereon in respect of such taxes; however, upon the Town of Sylvan Lake collecting any or all of the said taxes, penalties or costs, such collections shall forthwith be paid by the town to the County of Red Deer No. 23.

III. The assessor for the Town of Sylvan Lake shall for taxation purposes in the year 1975, re-assess or re-value the annexed lands and assessable improvements thereon which are by this Order annexed to the town, so that the assessment or valuation thereof shall be fair and equitable with other related lands and assessable improvements in the Town of Sylvan Lake.

IV. The chief provincial assessor, appointed pursuant to the provisions of The Municipalities Assessment and Equalization Act, shall for taxation or grant purposes commencing in the year 1975, re-assess, or re-value, as the case may be, all properties that are assessable or subject to valuation under the terms of The Electric Power and Pipe Line Assessment Act and The Municipal and Provincial Properties Valuation Act, and which lie within the areas that are by this Order annexed to the Town of Sylvan Lake, so that the assessment or valuation shall be fair and equitable with properties of a similar nature.

V. The effective date of this Order shall be the 1st day of January, 1975.

VI. Dated and signed at the City of Edmonton, in the Province of Alberta, this 15th day of July, 1974.

Certified a true copy,

B. CLARK, Secretary.

LOCAL AUTHORITIES BOARD,
I. MORRIS, Member.

SCHEDULE "A"

A SKETCH SHOWING THE GENERAL LOCATION
OF THE AREAS AFFECTED BY ORDER No. 7134

EFFECTIVE DATE: JANUARY 1, 1975



AFFECTED AREA(S)

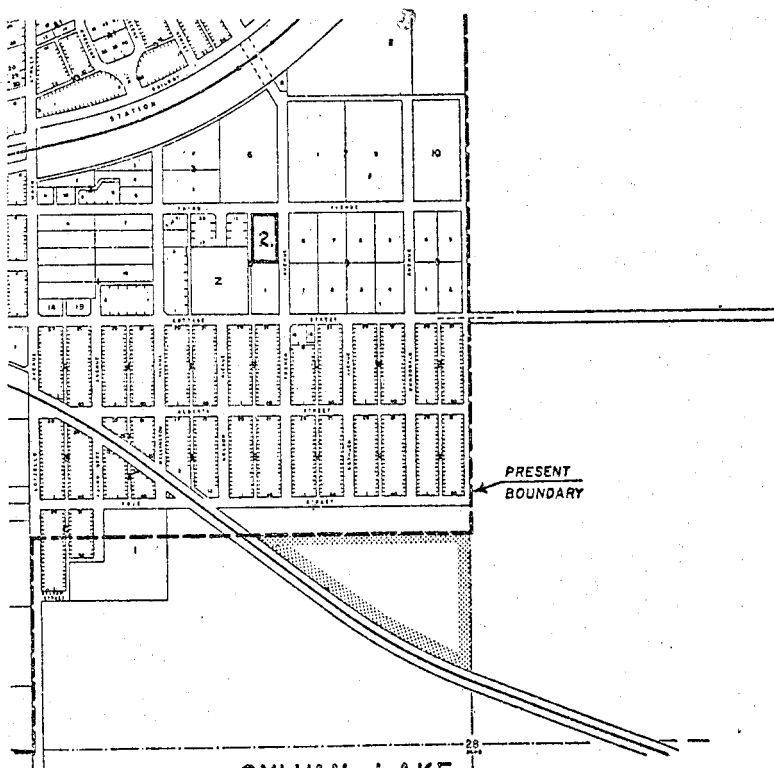

SYLVAN LAKE

TP. 38 R. 1 W. 5 M.