

GAZ: Aug 15/73

LOCAL AUTHORITIES BOARD.  
I. MORRIS, Member.

Order No.: 6477

File: L A 162-A

Before:

The Local Authorities Board for  
the Province of Alberta

In the matter of The Municipal  
Government Act:

And in the matter of an ap-  
plication by the Village of  
Crossfield, Alberta for annexa-  
tion of certain territory lying im-  
mediately adjacent thereto.

Pursuant to an application by the Village of Crossfield in the Province of Alberta for annexation of all that portion of the south-east quarter of section 35, township 28, range 1, west of the fifth meridian not presently contained within the limits of the said village, the Board conducted a public hearing of the matter in the said village on Wednesday, November 1st, 1972.

Representing the Village of Crossfield was Robert Pilon, Secretary-Treasurer.

The Municipal District of Rocky View No 44 was represented by Assistant Secretary-Treasurer Dan Konelsky and Councillor Jack Beddoes.

Calgary School Division No. 41 was represented by Mr. Jack Macdonell

Land owner Don Beddoes—part S.E. 35-28-1-5 also attended the hearing.

In the course of the hearing the village represented that it preferred to amend its application by excluding therefrom all that portion of the south-east quarter of section 35 lying easterly of the westerly limit of the C.P.R. right-of-way, stating that the village did not have direct access to parcels lying east of the tracks in S.E. 35.

The village submitted that it required the balance of the lands in S.E. 35 for urban expansion, there being an imminent shortage of residential lots in the present village limits

The area proposed for annexation—as revised—was stated to contain the village fair grounds and the School (Calgary School Division No 41) and contained desirable and available lands for residential and school expansion. It was represented that the area was economically serviceable from the village's sewer and water utilities

Mr Donald Beddoes spoke in favour of the annexation of that portion of his lands described in Certificate of Title No 170-M-79 in S.E. 35-28-1-5 which lay outside the village limits A tentative subdivision

plan of the whole of the Beddoes' lands described in Certificate of Title 170-M-79—both inside and outside the village—was filed with the Board.

Mr Konelsky advised the Board that the Council of the Municipal District of Rocky View had no objection to the revised application of the village being granted.

Mr Macdonell of Calgary School Division No. 41 and the village came to a ready and agreeable understanding concerning the requirement for additional school site land in the annexation area.

Mr Ellis R Banta owner of forty-three and six tenths (43.6) acres of farm lands in the annexation area, comprising a portion of his farm unit, advised the village that he would consent to annexation of his lands to the village provided that his lands continued to be treated as agricultural lands and taxed as such until subdivided. Secretary-treasurer Pilon advised the Board in the formal submission filed by the village that the village had already taken steps to negotiate through Alberta Housing Corporation for the purchase of the Banta lands with the view of acquiring a sufficient supply of lands to control rising lot prices. (Board Note. The purchase was duly made by the village subsequent to the hearing.)

After considering the evidence placed before it at the hearing, the Board announced its verbal decision to grant the application of the village as amended at the hearing by the Secretary-treasurer, effective on January 1st, 1973.

It is ordered therefore as follows:

- I That there be annexed to the Village of Crossfield in the Province of Alberta and thereupon be separated from the Municipal District of Rocky View No. 44, the following described lands:

All that portion of the south-east quarter of section 35 not presently within the limits of the Village of Crossfield, Alberta, and lying westerly of the westerly limit of C & E Railway Plan R.Y. 9, township 28, range 1, west of the fifth meridian

(A sketch showing the general location of the annexed lands is attached as Schedule "A".)
- II. Any taxes owing to the Municipal District of Rocky View No. 44 as at December 31, 1972, in respect of the aforementioned annexed properties shall transfer to and become payable to the Village of Crossfield, together with the amount of any lawful penalties and costs levied thereon in respect of such taxes, however, upon the Village of Crossfield collecting any or all of the said taxes, penalties or costs, such collections shall forthwith be paid by the village to the Municipal District of Rocky View No. 44
- III. The Assessor for the Village of Crossfield shall for taxation purposes in the year 1973, re-assess or re-value the annexed lands and assessable improvements thereon, so that the assessment or valuation thereof shall be fair and equitable with the other lands and assessable improvements in the village.
- IV. The Chief Provincial Assessor, appointed pursuant to the provisions of The Municipalities Assessment and Equalization Act, shall for taxation or grant purposes commencing in the year 1973, re-assess or re-value, as the case may be, all properties that are assessable or subject to valuation under the terms of The Electric Power and Pipe Line Assessment Act and The Municipal and Provincial Properties Valuation Act, and which lie within the areas that are

by this Order annexed to the Village of Crossfield, so that the assessment or valuation shall be fair and equitable with properties of a similar nature

V The effective date of this Order shall be the 1st day of January, 1973.

Dated and signed at the City of Edmonton, in the Province of Alberta, this 20th day of July, 1973

Certified a true copy,

B CLARK, Secretary

LOCAL AUTHORITIES BOARD,  
C G MACGREGOR, Chairman  
I. MORRIS, Member.

### SCHEDULE "A"

A SKETCH SHOWING THE GENERAL LOCATION  
OF THE AREAS AFFECTED BY ORDER No 6477  
EFFECTIVE DATE - JANUARY 1, 1973.

 AFFECTED AREA(S)

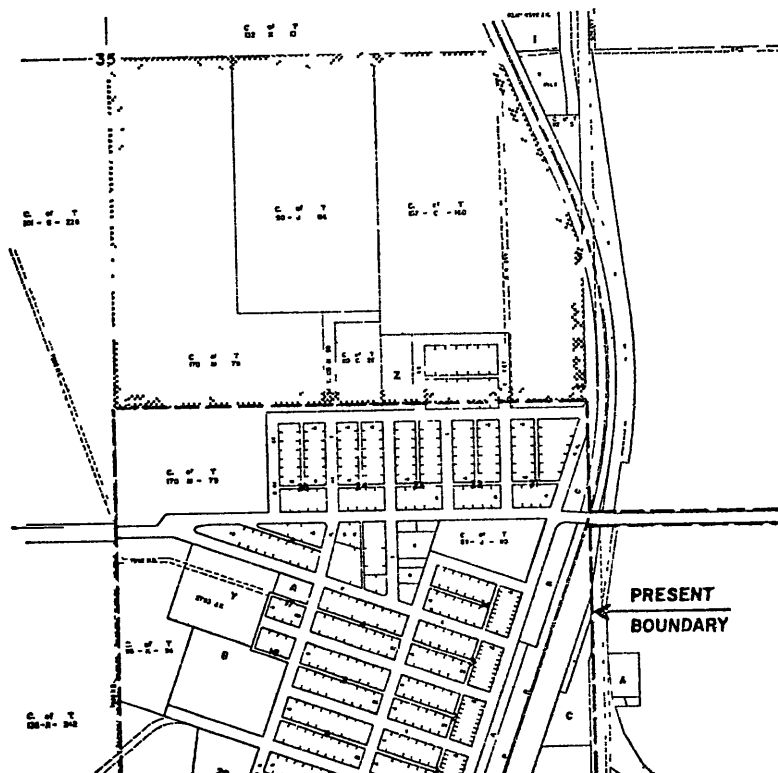

**CROSSFIELD**  
T.28 R.1 W5M