



Province of Alberta
Order in Council

O.C. 262 /2001

JUL 11 2001

ORDER IN COUNCIL

Approved and ordered:

Lieutenant Governor

The Lieutenant Governor in Council orders that

- (a) effective January 1, 2001, the land described in Appendix A and shown on the sketch in Appendix B is separated from Lacombe County and annexed to the Town of Blackfalds,
- (b) any taxes owing to Lacombe County at the end of December 31, 2000 in respect of the annexed land are transferred to and become payable to the Town of Blackfalds together with any lawful penalties and costs levied in respect of those taxes, and the Town of Blackfalds upon collecting those taxes, penalties or costs must pay them to Lacombe County, and
- (c) the assessor for the Town of Blackfalds must assess, for the purpose of taxation in 2001, the annexed land and the assessable improvements to it,

CHAIR

and makes the Order in Appendix C.

Alberta

For Information only

Recommended by: Minister of Municipal Affairs

Authority: Municipal Government Act
(sections 125 and 138)

APPENDIX A

DETAILED DESCRIPTION OF THE LANDS SEPARATED FROM LACOMBE COUNTY AND ANNEXED TO THE TOWN OF BLACKFALDS

ALL THAT PORTION OF THE NORTH WEST QUARTER OF SECTION TWENTY SIX (26), TOWNSHIP THIRTY NINE (39), RANGE TWENTY SEVEN (27), WEST OF THE FOURTH MERIDIAN, WHICH LIE SOUTH AND EAST OF A LINE DRAWN PARALLEL TO THE CENTRE LINE OF THE CALGARY AND EDMONTON RAILWAY, AS SHOWN ON RAILWAY PLAN C & E NO. 1, AND PERPENDICULARLY DISTANT SOUTH EASTERLY FORTY NINE AND FIVE TENTHS (49.5) FEET THEREFROM, EXCEPTING THEREOUT

- A) PLAN 2105BM - ROAD
- B) PLAN 8166ET - PIPELINE RIGHT OF WAY
- C) PLAN 4011EU - ROAD
- D) PLAN 5450KS - SUBDIVISION
- E) PLAN 6174MC - SUBDIVISION
- F) PLAN 2430NY - SUBDIVISION
- G) PLAN 3309RS - SUBDIVISION

ALL THAT PORTION OF THE NORTHWEST QUARTER OF SECTION TWENTY THREE (23), TOWNSHIP THIRTY NINE (39), RANGE TWENTY SEVEN (27), WEST OF THE FOURTH MERIDIAN, LYING NORTH OF THE MOST NORTHERLY RIGHT-OF-WAY OF SECONDARY HIGHWAY 597

ALL THAT PORTION OF THE NORTHEAST QUARTER OF SECTION TWENTY TWO (22), TOWNSHIP THIRTY NINE (39), RANGE TWENTY SEVEN (27), WEST OF THE FOURTH MERIDIAN, LYING NORTH OF THE MOST NORTHERLY RIGHT-OF-WAY OF SECONDARY HIGHWAY 597.

ALL THAT PORTION OF THE NORTHWEST QUARTER OF SECTION TWENTY TWO (22), TOWNSHIP THIRTY NINE (39), RANGE TWENTY SEVEN (27), WEST OF THE FOURTH MERIDIAN LYING NORTH OF THE MOST NORTHERLY RIGHT-OF-WAY OF SECONDARY HIGHWAY 597 AND EAST OF THE MOST EASTERLY RIGHT-OF-WAY OF HIGHWAY 2.

ALL THAT PORTION OF THE SOUTHWEST QUARTER OF SECTION TWENTY SEVEN (27), TOWNSHIP THIRTY NINE (39), RANGE TWENTY SEVEN (27) WEST OF THE FOURTH MERIDIAN, LYING EAST OF THE MOST EASTERLY RIGHT-OF-WAY OF HIGHWAY 2.

ALL INTERVENING ROAD ALLOWANCES, ROADWAY PLANS, AND RAILWAY RIGHTS-OF-WAY.

APPENDIX B

A SKETCH SHOWING THE GENERAL LOCATION OF AREAS
ANNEXED TO THE TOWN OF BLACKFALDS

AFFECTED AREA

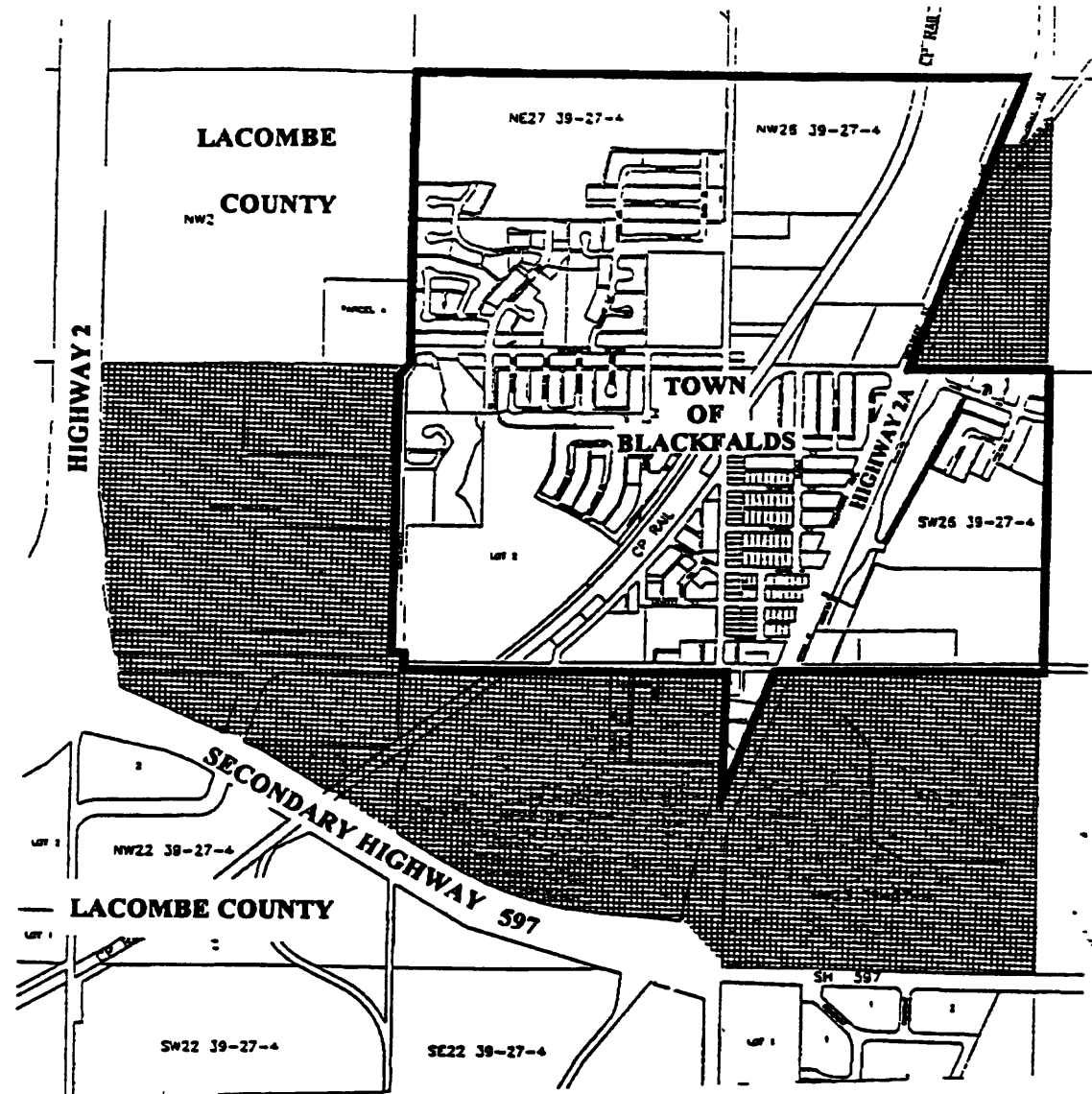
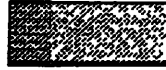

APPENDIX C

ORDER

- 1 In this Order "annexed land" means the land described in Appendix A and shown on the sketch in Appendix B
- 2 For taxation purposes in 2001 and later years up to and including 2010, the annexed land and the assessable improvements to it must
 - (a) be assessed by the Town of Blackfalds on the same basis as if they had remained in Lacombe County, and
 - (b) be taxed by the Town of Blackfalds in respect of each assessment class that applies to the annexed land and the assessable improvement to it using the tax rate established by Lacombe County
- 3 Section 2 ceases to apply to a portion of the annexed land and the assessable improvements to it in the taxation year immediately following the taxation year in which
 - (a) the portion becomes a new parcel of land created as a result of subdivision or separation of title by registered plan of subdivision or by instrument or any other method that occurs at the request of, or on behalf of, the landowner,
 - (b) the portion becomes a residual portion after a new parcel referred to in clause (a) has been created and the residual portion is 16 hectares or less,
 - (c) the portion is, at the request of or on behalf of the landowner, redesignated by an amendment to the Town of Blackfalds Land Use Bylaw, or
 - (d) the portion is connected to the water or sanitary sewer services provided by the Town of Blackfalds.
- 4 After section 2 ceases to apply to a portion of the annexed land in a taxation year, the portion of the annexed land and the assessable improvements to it must be assessed and taxed for the purposes of property taxes in that year on the same basis as the assessment and taxation of property of the same assessment class in the Town of Blackfalds.