



Province of Alberta
Order in Council

O.C. 230/2013

JUL 25 2013

ORDER IN COUNCIL

Approved and ordered:

Lieutenant Governor

The Lieutenant Governor in Council orders that

- (a) effective January 1, 2013, the land described in Appendix A and shown on the sketch in Appendix B is separated from Rocky View County and annexed to the Municipal District of Bighorn No. 8,
- (b) any taxes owing to Rocky View County at the end of December 31, 2012 in respect of the annexed land are transferred to and become payable to the Municipal District of Bighorn No. 8 together with any lawful penalties and costs levied in respect of those taxes and the Municipal District of Bighorn No. 8 upon collecting those taxes, penalties and costs must pay them to Rocky View County,
- (c) for the purposes of taxation in 2013,
 - (i) the assessor for Rocky View County must assess the annexed land and the assessable improvements to it, and
 - (ii) the Municipal District of Bighorn No. 8 must tax the annexed land and the assessable improvements to itin accordance with the order in Appendix C,
- (d) subject to clause (b), taxes payable in 2013 in respect of the annexed land and the assessable improvements to it are to be paid to and retained by the Municipal District of Bighorn No. 8, and
- (e) the assessor for the Municipal District of Bighorn No. 8 must, for the purposes of taxation in 2014 and subsequent years assess the annexed land and the assessable improvements to it in accordance with the order in Appendix C,

and makes the order in Appendix C.

CHAIR

For Information only

Recommended by:

Minister of Municipal Affairs

Authority:

Municipal Government Act
(section 126 and 138)

APPENDIX A

DETAILED DESCRIPTION OF THE LANDS SEPARATED FROM ROCKY VIEW COUNTY AND ANNEXED TO THE MUNICIPAL DISTRICT OF BIGHORN NO. 8

ALL THAT PORTION OF THE WEST HALF OF SECTION EIGHTEEN (18),
TOWNSHIP TWENTY-FIVE (25), RANGE FIVE (5) WEST OF THE FIFTH
MERIDIAN LYING WEST OF ROAD PLAN 5619JK.

ALL THAT PORTION OF THE NORTHWEST QUARTER OF SECTION SEVEN (7),
TOWNSHIP TWENTY-FIVE (25), RANGE FIVE (5) WEST OF THE FIFTH
MERIDIAN LYING WEST OF ROAD PLAN 8210957.

APPENDIX B

A SKETCH SHOWING THE GENERAL LOCATION OF THE AREA
ANNEXED TO THE MUNICIPAL DISTRICT OF BIGHORN NO.8

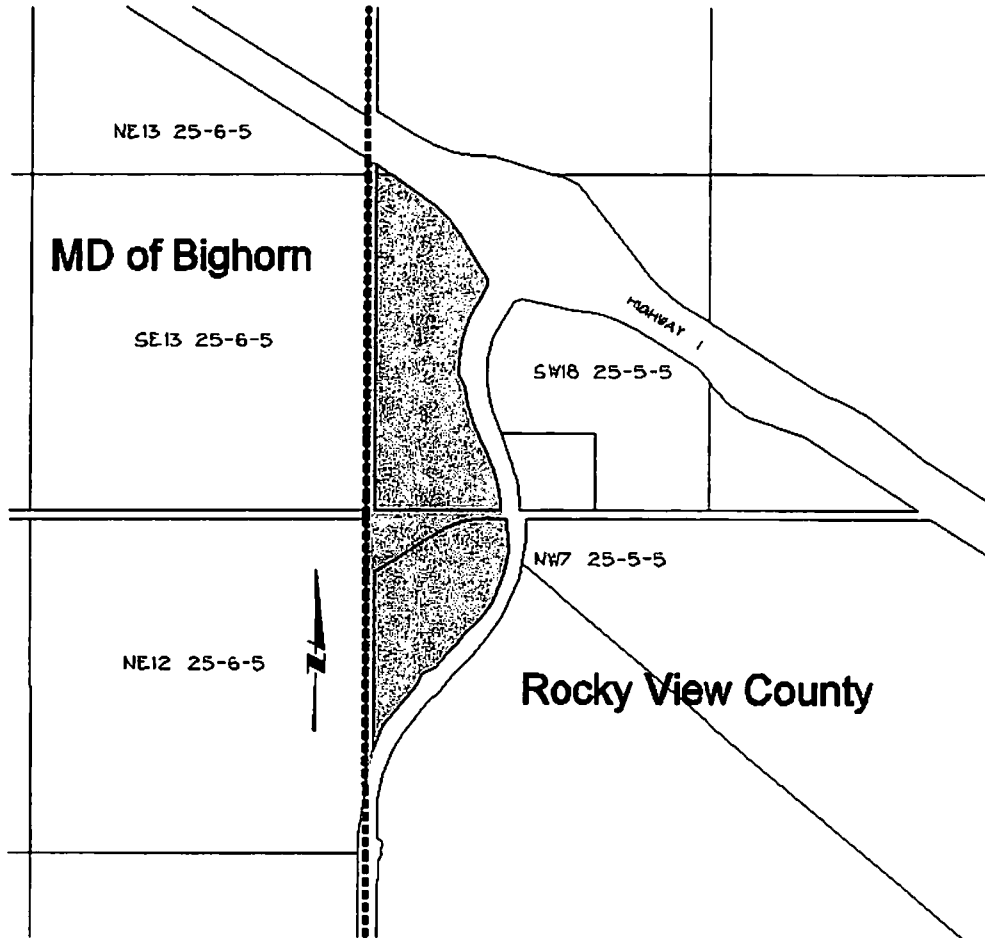

Legend

.....

Existing Boundary of Municipal District of Bighorn No. 8

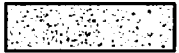

Annexation Area

APPENDIX C

ORDER

1 In this Order, “annexed land” means the land described in Appendix A and shown on the sketch in Appendix B.

2 For taxation purposes in 2013 and in subsequent years up to and including December 31, 2018, the annexed land and the assessable improvements to it must be taxed by the Municipal District of Bighorn No. 8 in respect of each assessment class that applies to the annexed land and the assessable improvements to it using

(a) the municipal tax rate established by Rocky View County, or

(b) the municipal tax rate established by the Municipal District of Bighorn No. 8,

whichever is lower, for property of the same assessment class.

3 After section 2 ceases to apply to the annexed land or any portion of it, the annexed land or portion and the assessable improvements to it must be taxed for the purposes of property taxes in the same manner as other property of the same assessment class in the Municipal District of Bighorn No. 8 is taxed.