



Province of Alberta
Order in Council

O.C. 126/2011

APR 14 2011

ORDER IN COUNCIL

Approved and ordered:

Lieutenant Governor

The Lieutenant Governor in Council orders that

- (a) effective January 1, 2011, the land described in Appendix A and shown on the sketch in Appendix B is separated from the Town of Strathmore and annexed to Wheatland County,
- (b) any taxes owing to the Town of Strathmore at the end of December 31, 2010 in respect of the annexed land are transferred to and become payable to Wheatland County together with any lawful penalties and costs levied in respect of those taxes, and Wheatland County upon collecting those taxes, penalties and costs must pay them to the Town of Strathmore, and
- (c) the assessor for Wheatland County must assess the annexed land and the assessable improvements to it for the purposes of taxation in 2012 and subsequent years.

CHAIR

For Information only

Recommended by: Minister of Municipal Affairs

Authority: Municipal Government Act
(sections 126 and 138)

APPENDIX A

DETAILED DESCRIPTION OF THE LANDS SEPARATED FROM THE TOWN OF STRATHMORE AND ANNEXED TO WHEATLAND COUNTY

THAT PORTION OF PLAN 061 2529, BLOCK 3, LOT 3 LYING WITHIN THE SOUTHWEST QUARTER OF SECTION TWENTY-ONE (21), TOWNSHIP TWENTY-FOUR (24), RANGE TWENTY-FIVE (25) WEST OF THE FOURTH MERIDIAN AND INCLUDING ALL THAT PORTION OF THE NORTH-SOUTH ROAD ALLOWANCE ADJACENT TO THE WEST SIDE OF SAID QUARTER SECTION LYING NORTH OF THE PROJECTION WEST OF THE SOUTHERNMOST POINT OF PLAN 061 2529, BLOCK 3, LOT 3.

APPENDIX B

A SKETCH SHOWING THE GENERAL LOCATION OF THE AREAS ANNEXED TO WHEATLAND COUNTY

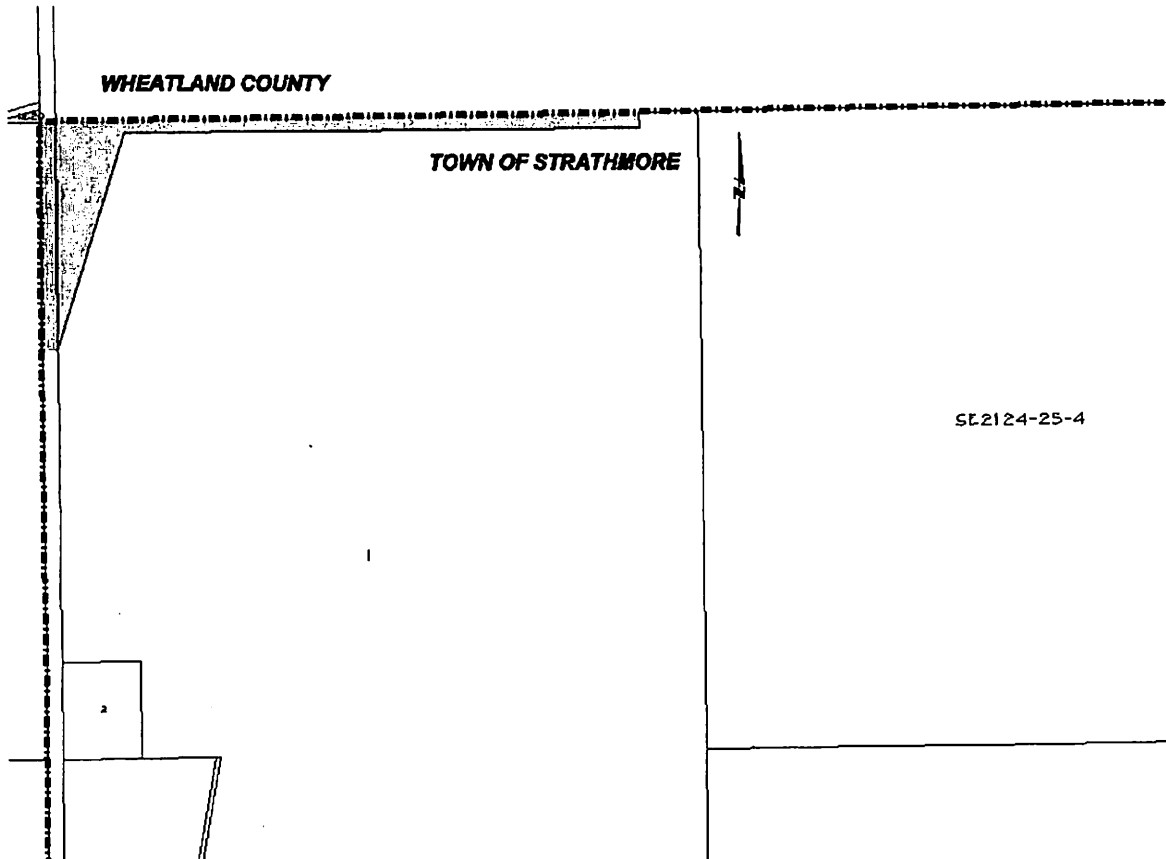

Legend

.....

Existing Wheatland County - Town of Strathmore Boundary



Annexation Area